

HIGH PRESSURE COMPRESSORS



PARAMINA
Air Compressors Manufacturers

“Six Decades of experience and specialization, together with new ideas and the proven reliability of our compressors and compressed air systems.”

Founded in **1966**, **PARAMINA SA** deals exclusively with **compressed air**; driven to the **third generation** of ownership as a manufacturer of **high-pressure (420bar max.) piston air compressors, screw air compressors** and **auxiliary compressed air systems** suitable for **Breathing Air** as well as **Industrial applications** in:

- Firefighting
- Diving & Medical Engineering
- Defense (air force, navy, army)
- Oil & Gas/H₂S protection
- Shipping
- Gas Industry (Nitrogen, Helium, Argon)
- Paintball & Shooting Sports
- Motorsports
- Industrial & General-Purpose Air



CERTIFICATES



ACHIEVEMENTS

- Robust Manufacturing based on quality, endurance and low operational cost.
- Extensive and specialized knowledge of our engineers.
- 3D Mechanical Design & Engineering.
- Flexibility.
- Personal & Direct approach to all customers.
- Instant response to all inquiries.
- Short & Prompt deliveries.
- Rapid & Immediate service support.
- Full availability of all spare parts in stock.
- Low priced spare parts.
- Custom design solutions according to customers' demands.
- Free sales & service training in our facilities for all our partners.
- Quality Management system according to EN ISO 9001:2015 & Environmental management system according to EN ISO 14001:2015, Certified by TÜV AUSTRIA, for the entire production process, from Research & Development to Manufacturing, Sales and After Sales Services for all our air compressors and air processing equipment. We apply also Health & Safety management systems.
- CE & UKCA declaration of conformity by independent accredited bodies & compliance with EU & UK directives of all our air compressors and air processing equipment.
- 3rd party laboratories tests / analyses depending on projects requirements .
- IACS approved and certified products for marine industry.
- ATEX approved and certified products for Oil & Gas industry.
- Compliance with all international standards and regulations in order to reassure the final product quality and user's safety during operation. PARAMINA's own manufacturing products such as Compressors, Dryers, Filtration Systems, Filling Panels, Storage Systems, Air Quality Control & Measuring Systems, Safety Valves, Filling Valves, Filling Hoses, Pressure Maintaining Valves, are tested ONE by ONE individually, under strict procedures and with the latest pressure testing equipment.
- Product Liability Insurance for all our customers.
- Worldwide Sales & Service network.

PARAMINA pioneers the first use of an adjusting screw compressor on a tractor (5 m³/min, 8 bar).



PARAMINA commences the production of high pressure breathing air compressors up to 350bar.

PARAMINA extends its screw compressor series, up to 110 kW.

PARAMINA installs variable speed technology (inverter) to the whole range of screw compressors and develops the most contemporary energy saving systems for any compressed air system installation.

PARAMINA extends its high pressure compressor series, with the new model Cyclone, 24-36 m³/h – 350 bar.

PARAMINA increases the maximum working pressure of its high pressure compressor models Typhoon & Cyclone, up to 420 bar.

New entrance in our product range, PARAMINA Humidity Control device – including humidity sensor & digital monitoring unit.



PARAMINA celebrates its 50year anniversary.

PARAMINA proudly enters deeper in the oil & gas market with our new ATEX Cyclone Silent 24 Electric compressor model 24 m³/h -350bar max, specifically designed for explosive environments.

New generation led touch Controller revolutionizing our compressors control & performance monitoring via Air Cloud App.

1966 Birth of PARAMINA

1973

1981 PARAMINA is the first company in Greece to begin the manufacture of screw compressors.



1995

1997 One of the first Greek Companies, but worldwide as well, to start the quality management procedures for the certification of ISO 9001 and CE.

2002

2003 PARAMINA begins with great success to export its products in the international market.



London Dive Show

2004

2005 PARAMINA moves to the new factory aiming to further development of its products and services.



2007

2010 PARAMINA manufactures high pressure refrigerated dryer "CRYO", 36 m³/h – 350bar max.

2012

2013 PARAMINA begins the production of new high pressure piston gas compressors suitable for Nitrogen (N₂), Helium (He), Argon (Ar). Mistral, Typhoon & Cyclone Gas series, from 6.6 m³/h to 36 m³/h – 350bar max.

2014

2015 PARAMINA launches the new "Force" in our high pressure compressor series, Notus model, 10 m³/h – 350bar max.

2016

2019 Newly designed Typhoon compressor models, Tropical series specialized for high ambient temperatures, increased humidity and contaminated environment. Electric & Diesel version, 19,2 m³ /h – 350bar max.

2021

2022 PARAMINA introduces new breathing air compressor model Cyclone Classic 24 Diesel, 24 m³/h – 350bar max.

2024

“All Mistral M6 models provide the lowest speed rotation of the market, @1200rpm.”

MISTRAL

MISTRAL, PARAMINA's “petit” mobile high pressure piston compressor. The unit is 3-staged, air cooled, oil lubricated and **easy to transport due to the built-in wheels**.

MISTRAL provides a reliable source of breathing air **according to EN 12021** due to the unique purification system (a coalescing prefilter installed before the active carbon/molecular sieve cartridge - hopcalite). It is **suitable for private divers, small diving shops, diving boats, yachts and small paintball teams**.

MISTRAL's very low turning speed accomplishes low noise level, almost zero vibration and ensures long life operation.

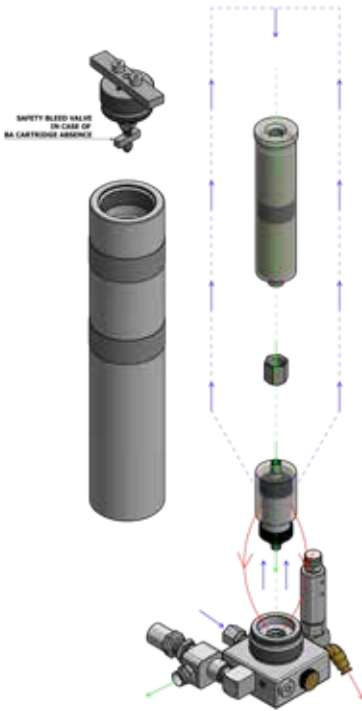

Combined Breathing Air Filter D80x375



M6/M8 - EM/ET



Technical Data

Model	Power	Max. Pressure bar	FAD *		Speed rpm	Dimensions cm			Weight Kg
			m ³ /h	lit/min		L	W	H	
M6-BZ	3.6kW 4stroke petrol	350	6.2	103	1200	88	43	51	55-65
M6-EM	2.2kW/220-230V/50-60Hz	350	6.2	103	1200	78	43	49	53-73
M6-ET	2.2kW/400-440V/50-60Hz	350	6.2	103	1200	78	43	49	53-73
M8-BZ	4.1kW 4stroke petrol	350	8.4	140	1750	88	43	51	65-73
M8-EM	3.7kW/220-230V/50-60Hz	350	8.4	140	1750	78	43	49	67-85
M8-ET	3kW/400-440V/50-60Hz	350	8.4	140	1750	78	43	49	67-85

- Oil capacity: 500ml special synthetic compressor oil.
- ◆ Optional: Classic Version (LxWxH: 94x53x70 cm, 118 kg).
- * Measured by cylinder filling (10 lt) from 0-200 bar ±5%.



Adaptor DIN 300 to DIN 200 (optional)



Classic ET

Design Specifications

	M6-EM, M8-EM, M6-ET, M8-ET	M6-BZ, M8-BZ
Micronic air inlet filter	●	●
Large Stainless Steel Intercoolers - Aftercooler	●	●
Safety Valves in all stages	●	●
Condensate Separator after 2 nd Stage	●	●
Combined BA Filter including Coalescing Pre-filter (0.5 mg/m ³ oil residual) and B.A. cartridge (AC/MS + HP), with the supply of absolutely clean air exceeding by far the requirements of EN12021	●	●
Pressure maintaining & non return valve for extended filtration	●	●
Manual condensate drains	●	●
Kevlar filling hose (1.2m) with stainless steel fittings and DIN/INT'L connector	●	●
Final stage Manometer	●	●
Automatic belt tensioning system	●	●
Wheels for easy transport	●	●
Electric hourmeter	●	■
Vibration hourmeter/service timer (Running hours, BA filter/oil service hours)	◆	●
Motor thermal overload protection	●	■
Start/Stop switch	●	■
Automatic stop system	◆	◆
Automatic start system	◆	■
Automatic condensate drains with manual backups	◆	■
Condensate collecting tank	◆	■
Dual pressure filling facility, allowing 225/330 bar alternative filling	◆	◆
Safety Bleed valve in case of BA Cartridge absence	◆	◆
1.5m air inlet hose with particle strainer	◆	●
Special voltage/frequency: 3x230V/60Hz	●	■

● Standard | ◆ Optional | ■ Not Applicable



M6/M8 - BZ

“Notus Classic models provide fully automated versions as an option.”

NOTUS, PARAMINA’s “mid-range” high pressure piston compressor series. Heavy duty design for continuous operation during the day, easy-to-move, 3-staged, oil lubricated and air cooled, offering pure breathing air according to EN 12021.

NOTUS is suitable for indoor or open area installations, mobile rescue squads, fire trucks, diving boats & paintball teams. Its robust construction makes it suitable for several industrial applications as well.



N10-EM/ET Open



N10-ET Classic

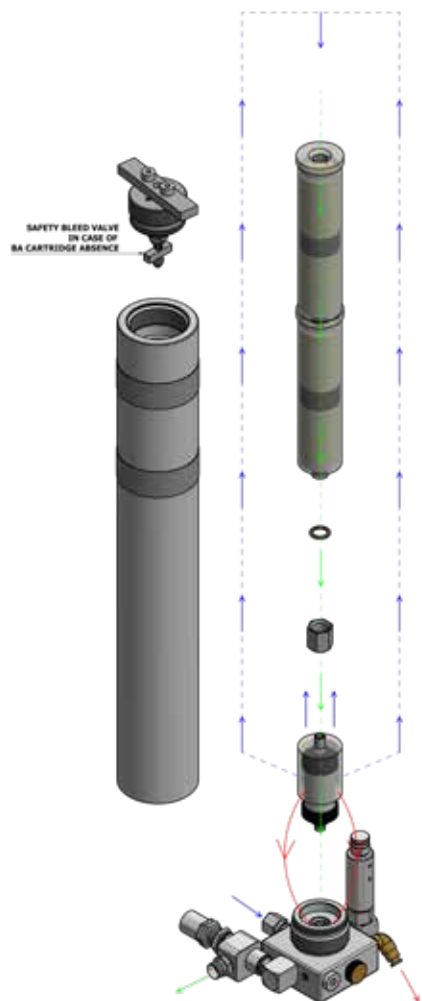

Combined Breathing Air Filter D80x560

Technical Data

Model	Power	Max. Pressure	FAD *		Speed rpm	Dimensions cm			Weight Kg
		bar	m ³ /h	lit/min		L	W	H	
N10-EM Open	3.7kW/220-230V/50-60Hz	350	10.2	170	1400	110	53	68	113-128
N10-ET Open	4kW/400-440V/50-60Hz	350	10.2	170	1400	110	53	68	129-135
N10-ET Classic	4kW/400-440V/50-60Hz	350	10.2	170	1400	115	53	74	149-155
N10-BZ Open	4.1kW 4stroke petrol	350	10.2	170	1400	110	53	68	86

● Oil capacity: 1.2 lit special synthetic compressor oil.
 * Measured by cylinder filling (10 lt) from 0-200 bar ±5%.

Design Specifications

	N10-EM Open	N10-ET Open	N10-ET Classic	N10-BZ Open
Micronic Air Inlet Filter	●	●	●	●
Large Stainless Steel Intercoolers - Aftercooler in all stages	●	●	●	●
Safety Valves in all stages	●	●	●	●
Condensate Separator after 2 nd Stage	●	●	●	●
Combined BA Filter including Coalescing Pre-filter (0.5mg/m ³ oil residual) and 2 x BA cartridges (AC/MS + HP), with the supply of absolutely clean air exceeding by far the requirements of EN 12021	●	●	●	●
Pressure maintaining & non-return valve for extended filtration	●	●	●	●
Manual Condensate Drains	●	●	●	●
Kevlar filling hose (1.2m) with stainless steel fittings and DIN/INT'L connector	●	●	●	●
Interstage / Final Stage manometer	●	●	●	●
Automatic belt tensioning system	●	●	●	●
Handles for easy lifting	●	●	■	●
Start/Stop switch	●	●	●	■
Motor thermal overload protection	●	●	●	■
Emergency Stop button & Main Switch	■	■	●	■
24VAC secondary voltage providing safety during routine operation	■	■	●	■
Electric hourmeter	●	●	●	■
Vibration hourmeter / service timer (Running hours, BA filter / oil service hours)	◆	◆	◆	●
Automatic stop system	◆	◆	◆	◆
Automatic start system	◆	◆	◆	■
Automatic condensate drains with manual backups + Condensate collecting tank	◆	◆	◆	■
Dual pressure filling facility, allowing 225/330bar alternative filling	◆	◆	◆	◆
Star/Delta starter system	■	■	◆	■
Low oil level monitoring / alarm / shutdown	■	■	◆	■
High temperature monitoring / alarm / shutdown	■	■	◆	■
Remote start/stop	■	■	◆	■
Final Stage Condensate separator	◆	◆	◆	◆
Safety Bleed valve in case of BA Cartridge absence	◆	◆	◆	◆
1.5m air inlet hose with particle strainer	◆	◆	◆	●
Special voltage/frequency 3x230V/60Hz * 460-480V/60Hz	■	■	◆	■

● Standard | ◆ Optional | ■ Not Applicable



N10-BZ Open

“All Typhoon Electric versions provide automatic stop & automatic condensate drain facility as standard equipment.”

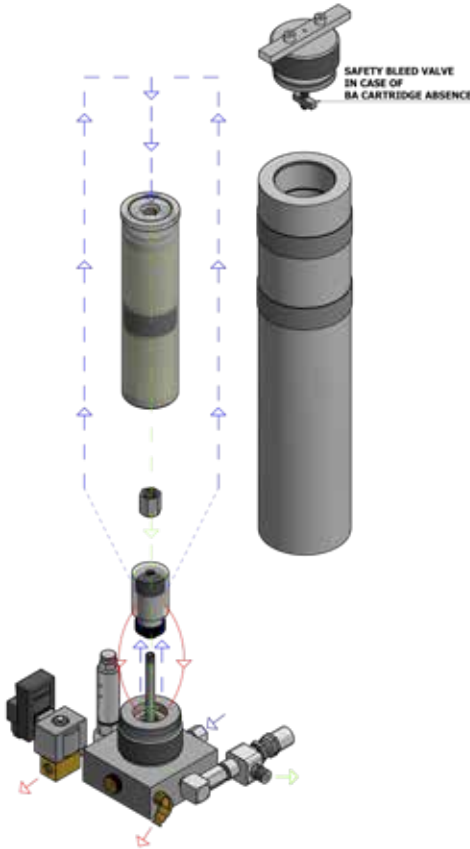

Combined Breathing Air Filter
 • D80x560
 • D110x495

TYPHOON, PARAMINA's **professional**, 3-staged, air-cooled & oil lubricated high pressure piston compressor, **comprising of 15 standard models**, with **very low turning speed** and pure breathing air according to EN 12021, making it a perfect solution for any breathing air, paintball or industrial application; i.e. fire rescue teams, military units, diving shops, paintball clubs and others.

The series consists of three versions:

- Open Framed Portable — With the option of electric motor, petrol or diesel engine for exterior use.
- Classic Stationary — With the option of electric motor.
- Silent — With soundproof insulation enabling it to operate in areas where the noise level is of issue. Includes digital control panel driving, controlling, protecting and ensuring the safe operation of the compressor.

Technical Data

Model	Power	Max. Pressure	FAD *		Speed rpm	Dimensions cm			Weight Kg
		bar	m ³ /h	lit/min		L	W	H	
Silent 15E *	5.5kW/400-440V/50-60Hz	350/420	15	250	1100	80	98	118	244-260
Silent 18E *	7.5kW/400-440V/50-60Hz	350/420	18/19	300/320	1290/1380	80	98	118	263-269
Open 15E *	5.5kW/400-440V/50-60Hz	350	15	250	1100	109	54	83	185-191
Open 18E	7.5kW/400-440V/50-60Hz	350	18/19	300/320	1290/1380	109	54	83	187-211
Classic 15E	5.5kW/400-440V/50-60Hz	350/420	15	250	1100	71	125	83	216-232
Classic 18E	7.5kW/400-440V/50-60Hz	350/420	18/19	300/320	1290/1380	71	125	83	226-247
Twin 15E	2x5.5kW/400-440V/50-60Hz	350	2x15	2x250	1100	134	63	172	421-437
Twin 18E	2x7.5kW/400-440V/50-60Hz	350	2x18	2x300	1290	134	63	172	436-456

- Oil capacity: 1.6 lit special synthetic compressor oil.
- Noise level: Silent 15E - 69 dB(A) @1m, Silent 18E - 70 dB(A) @1m.
- * **NEW Economy Versions: Open 13ES, Open 15ES = Manually Operated, Silent 15ES, Silent 18ES = Without digital Controller.**
- * Measured by cylinder filling (10 lt) from 0-200 bar ±5%.



Silent

Design Specifications

	Open/ Classic 15E, 18E	Silent 15E, 18E	Twin 15,18E
Micronic air inlet filter	●	●	●
Large Stainless Steel Intercoolers - Aftercooler	●	●	●
Safety Valves in all stages	●	●	●
Condensate Separator after 2 nd Stage	●	●	●
Combined BA Filter including Coalescing Pre-filter (0.5 mg/m ³ oil residual) and BA cartridge (AC/MS + HP option), with the supply of absolutely clean air exceeding by far the requirements of EN12021	● ¹	● ¹	● ¹
Pressure maintaining & non return valve for extended filtration	●	●	●
2 Kevlar filling hoses (1.2m each) with stainless steel fittings and DIN/INT'L connectors	●	●	■
Lever operated on/off filling valves with automatic ventilation	◆	●	■
Interstage/Final stage Manometers	●	●	●
Automatic belt tensioning system	●	●	●
Soundproof insulation ensuring very low noise level	■	●	■
Electric hourmeter	●	●	●
Vibration hourmeter/service timer (Running hours, BA filter/oil service hours)	◆	■	◆
LED TOUCH controller providing operation (running hrs, filling pressure, operating temperature) & service (alarms, faults record history, maintenance hrs) data via Air Cloud App remotely	■	●	■
Star/Delta starter system	● ²	● ²	●
Start/Stop switch	●	●	●
Motor thermal overload protection	●	●	●
Automatic stop system	●	●	●
Automatic start system	◆	●	◆
Automatic condensate drains with manual backups + Condensate collecting tank	●	●	●
24V secondary voltage providing safety during routine operation	●	●	●
Emergency Stop button & Main Switch	●	●	●
Interstage pressure sensors providing emergency shutdown in case of overpressure	◆	●	◆
Dual pressure filling facility, allowing 225/330 bar simultaneous filling via pressure regulator	◆	◆	■
Final stage Condensate Separator	◆	◆	◆
1.5m air inlet hose with particle strainer	◆	◆	◆
Oil Pump Lubrication System c/w oil cooler & oil filter for high operating temperatures, retaining the high quality of lubricant during its lifetime	◆	◆	◆
Safety Bleed valve in case of BA Cartridge absence	◆	◆	◆
High Temperature monitoring / alarm / shutdown	◆	●	◆
Low Oil level monitoring / alarm / shutdown	◆	◆	●
Remote Start/Stop - Remote Load/Unload	◆	●	◆
Special Voltage/Frequency: 230V/50Hz-60Hz * 3x230V/60Hz * 460-480V/60Hz	◆	◆	◆
Voltage failure and Phase Rotation Safety device	◆	◆	◆
Carbon Monoxide (CO) monitoring/alarm/shutdown system	◆	◆	◆
Hydrogen Sulfide (H ₂ S) monitoring/alarm/shutdown system	◆	◆	◆
Humidity (H ₂ O) monitoring / alarm / shutdown system	◆	◆	◆
Carbon Dioxide (CO ₂) monitoring / alarm / shutdown system	◆	◆	◆
OIL-VOC monitoring / alarm / shutdown system	◆	◆	◆

● Standard | ◆ Optional | ■ Not Applicable

¹ D80x560 Typhoon 15 models,
D110x495 Typhoon 18 models (option for Typhoon 15 models),
D110x728 Typhoon Twin 15E & 18E.

² Standard on Typhoon 18 models - option on Typhoon 15 models.



Twin



Open "E"



Classic

“All Typhoon Petrol & Diesel versions provide electric starting system as standard equipment.”

Technical Data

Model	Power	Max. Pressure	FAD *		Speed rpm	Dimensions cm			Weight Kg
		bar	m³/h	lit/min		L	W	H	
Open 15D	6.8kW Diesel	350	15	250	1100	128	52	78	198-210
Open 15P	6.3kW 4stroke Petrol	350	15	250	1100	128	52	78	169-174
Open 18P	8.7kW 4stroke Petrol	350	18	300	1300	128	52	78	187-192

- Oil capacity: 1.6 lit special synthetic compressor oil.
- * Measured by cylinder filling (10 lt) from 0-200 bar ±5%.

Design Specifications

	Open 15P, 18P, 15D
Micronic air inlet filter	●
Large Stainless Steel Intercoolers - Aftercooler	●
Safety Valves in all stages	●
Condensate Separator after 2 nd Stage	●
Combined BA Filter including Coalescing Pre-filter (0.5 mg/m³ oil residual) and BA cartridge (AC/MS + HP), with the supply of absolutely clean air exceeding by far the requirements of EN12021	● ¹
Pressure maintaining & non return valve for extended filtration	●
Manual condensate drains	●
2 Kevlar filling hoses (1.2m each) with stainless steel fittings and DIN/INTL connectors	●
Interstage/Final stage Manometers	●
Automatic belt tensioning system	●
1.5m air inlet hose with particle strainer	●
Vibration hourmeter/service timer (Running hours, BA filter/oil service hours)	●
Electric Starter/Battery fitted	●
Dual pressure filling facility, allowing 225/330 bar simultaneous filling via pressure regulator	◆
Oil Pump Lubrication System c/w oil cooler & oil filter for extreme high operating temperatures & maintain the high quality of lubricant during its lifetime	◆
Safety Bleed valve in case of BA Cartridge absence	◆
Final stage Condensate Separator	◆
Automatic stop system	◆
Automatic condensate drains with manual backups + Condensate collecting tank	◆
High Temperature monitoring / alarm / shutdown system	◆
Low Oil level monitoring / alarm / shutdown system	◆
Carbon Monoxide (CO) monitoring / alarm / shutdown system	◆
Hydrogen Sulfide (H ₂ S) monitoring / alarm / shutdown system	◆
Humidity (H ₂ O) monitoring / alarm / shutdown system	◆
Carbon Dioxide (CO ₂) monitoring / alarm / shutdown system	◆
OIL-VOC monitoring / alarm / shutdown system	◆

● Standard | ◆ Optional

¹ D80 x 560 Typhoon 15 models, D110 x 495 Typhoon 18 models (option for Typhoon 15 models).



Petrol

Diesel

PARAMINA Breathing Air System exceeding EN12021 & International Standards

1. PARAMINA 'SMART' CONTROLLER

PARAMINA's Touch Controller built on the functionality and easy-to-use graphical Interface, revolutionizes compressor control & performance monitoring:

- Fully Automatic compressor control.
- Intuitive colour graphic & led touch display, plus physical START, STOP & RESET keys.
- Durable ABS plastic enclosure with IP65/NEMA4 fascia protection.
- 'Built-in' phase protection.
- Prime and Fan motor current protection.
- Convenient terminal arrangement e.g. potential free contact Running and Master fault.
- MODBUS ready.
- Industry 4.0 / IOT (CLOUD) ready.
- Intelligent Maintenance/Service Guide.
- Control Management of up to 8 compressors regardless of brand.



PARAMINA 'AIR CLOUD' APP

PARAMINA AIRCLOUD is the App that provides a visual window to your phone, tablet or pc of your compressor performance with real time data and analytics, enabling you to improve your compressor network efficiency, achieve 24/7 – 360° visibility of operation/ service status, cut waste and reduce carbon emission.



2. Air Compressor producing high pressure breathing air up to 420 bar max, 103 lit/min up to 600 ltr/min.
3. Refrigerated Air Dryer drying compressed air down to 3 °C dew point before entering the BA Filters, thus increasing BA cartridges lifetime and reducing compressor's service costs.
4. BA Filtration Systems (Active Carbon / Molecular Sieve / Hopcalite + coalescing prefilter 0,5 mg/m³) ensuring best breathing air quality – custom design availability.
5. Automatic Filling System giving priority to BA cylinders filling either from the Compressor or the Storage System.
6. Storage System with reverted cylinders for no moisture accumulation at their bottom, at any pressure and number of cylinders combination – custom design availability.
7. Air Quality Control Systems for continuous monitoring & alarm of O₂, CO, CO₂, H₂O, VOC (Oil) & H₂S limits, reassuring premium inhaled compressed air.
8. Wall-mounted filling panels at any pressure and number of filling hoses combination – custom design availability.



“All Typhoon Tropical models are designed for high ambient temperatures (50 °C) & increased humidity environment.”

Typhoon Tropical series, 3-staged, air-cooled & oil lubricated high pressure piston compressor, ensuring safe operation and pure breathing air quality acc. to EN 12021 directive, **even in contaminated environment via CO, H₂S, H₂O monitoring and alarm.**

- Heavy Duty Design
- Extreme Operating Conditions

Technical Data

Model	Power	Max. Pressure	FAD *		Speed	Dimensions cm			Weight Kg
		bar	m ³ /h	lit/min		L	W	H	
Classic 18E TROPICAL	9.2kW/400-440V/50-60Hz	350	19.2	320	1380	152	81	107	353
Classic 18D TROPICAL	11.2kW Diesel	350	19.2	320	1380	142	74	102	427

- Oil capacity: 1.6 lit special synthetic compressor oil.
- * Measured by cylinder filling (10 lt) from 0-200 bar ±5%.

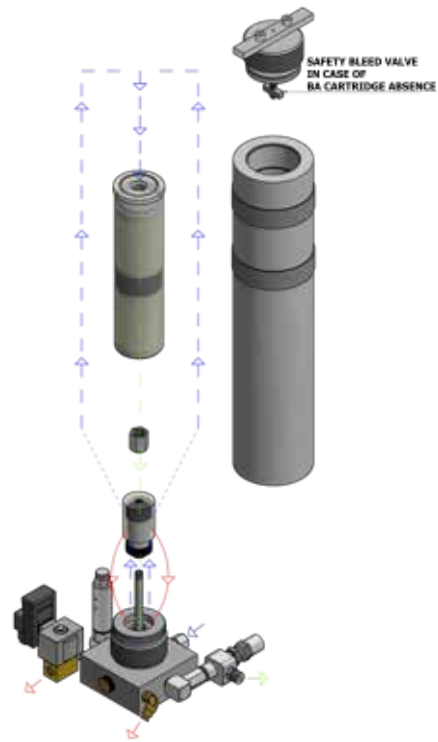

Combined Breathing Air Filter D110x495



CLASSIC 18 ELECTRIC TROPICAL



CLASSIC 18 DIESEL TROPICAL



Dual Pressure 200 & 300 bar Filling

Design Specifications

	Classic 18E TROPICAL	Classic 18D TROPICAL
Micronic air inlet filter	●	●
1.5m air inlet hose with particle strainer	◆	●
Large Stainless Steel Intercoolers - Aftercooler	●	●
Safety Valves in all stages	●	●
Condensate Separators after 1 st , 2 nd and final stage	●	●
Combined BA Filter including Coalescing Pre-filter (0.5 mg/m ³ oil residual) and BA cartridge (AC/MS + HP), with the supply of absolutely clean air exceeding by far the requirements of EN12021	●	●
Pressure maintaining & non return valve for extended filtration	●	●
2 Kevlar filling hoses (1.2m each) with stainless steel fittings and DIN/INTL connectors	●	●
Lever operated on/off filling valves with automatic ventilation	●	●
Interstage/Final stage Manometers	●	●
Automatic belt tensioning system	●	●
Lifting eyebolts for easier transportation	●	●
Start/Stop switch	●	●
Automatic stop system	●	●
Automatic condensate drains with manual backups in all stages + Condensate collecting tank	●	●
High Temperature monitoring / alarm / shutdown	●	●
Low Oil level monitoring / alarm / shutdown	●	●
Electric Hourmeter	●	■
Vibration hourmeter/service timer (Running hours, BA filter/oil service hours)	◆	●
Voltage Failure & Phase Rotation Safety Device	●	■
Motor thermal overload protection	●	■
Star/Delta starter system	●	■
Electric Starter/Battery fitted	■	●
24V secondary voltage providing safety during routine operation	●	■
Emergency Stop button & Main Switch	●	■
LED TOUCH controller providing operation (running hrs, filling pressure, operating temperature) & service (alarms, faults record history, maintenance hrs) data via Air Cloud App remotely	◆	■
Oil Pump Lubrication System c/w oil cooler & oil filter for extreme high operating temperatures & maintain the high quality of lubricant during its lifetime	◆	◆
Interstage pressure sensors providing emergency shutdown in case of overpressure	◆	■
Remote Start/Stop - Remote Load/Unload	◆	■
Special Voltage/Frequency: 230V/50Hz-60Hz * 3x230V/60Hz * 460-480V/60Hz	◆	■
Automatic start system	◆	■
Dual pressure filling facility, allowing 225/330 bar simultaneous filling via pressure regulator	◆	◆
Safety Bleed valve in case of BA Cartridge absence	◆	◆
Carbon Monoxide (CO) monitoring / alarm / shutdown system	◆	◆
Hydrogen Sulfide (H ₂ S) monitoring / alarm / shutdown system	◆	◆
Humidity (H ₂ O) monitoring / alarm / shutdown system	◆	◆
Carbon Dioxide (CO ₂) monitoring / alarm / shutdown system	◆	◆
OIL-VOC monitoring / alarm / shutdown system	◆	◆

● Standard | ◆ Optional | ■ Not Applicable

“All Cyclone models are fully automated and provide 4-stages compression.”

CYCLONE, PARAMINA 's **Silent Force**. 4-staged, air cooled & oil lubricated high pressure piston compressor, combining low turning speed operation, soundproof insulated doors, optimum cooling system, and easy-to-use digital control panel, providing smooth, safe, quiet and long life operation. Easy access through large openings ensuring quick maintenance.

The multi stage purification system guarantees absolute clean air according to EN 12021, making it applicable in numerous breathing air sectors including fish farms, military, fire brigades and diving centers.

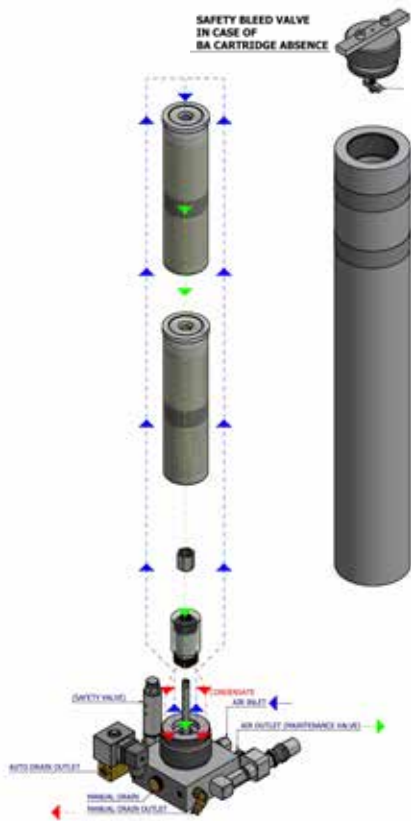

Combined Breathing Air Filter
D110 x725

Technical Data

Model	Power	Max. Pressure bar	FAD *		Speed rpm	Dimensions cm			Weight Kg
			m³/h	lit/min		L	W	H	
Silent 24E *	7.5kW/400-440V /50-60Hz	350/420	24	400	700	81	124	178	498-510
Classic 24D	11.2kW Diesel	350	24	400	700	169	96	113	560-570
Silent 30E	11kW/400-440V /50-60Hz	350/420	30	500	900	81	124	178	549-556
Silent 36E	15kW/400-440V /50-60Hz	350/420	36	600	1000	81	124	178	551-585

- Oil capacity: 2.1 lit special synthetic compressor oil.
- Noise level: C. Silent 24 - 72 dB(A) @1m, C. Silent 30 - 73 dB(A) @1m, C. Silent 36 - 75 dB(A) @1m.
- * ATEX version available exclusively designed for explosive environments.
- * Measured by cylinder filling (10 lt) from 0-200 bar ±5%.



Silent "E"

Design Specifications

	SILENT 24E,30E,36E	CLASSIC 24D
Micronic air inlet filter	●	●
1,5m air inlet hose with particle strainer	◆	●
High efficiency aluminium Intercooler (1 st & 2 nd stage)	●	■
Large Stainless Steel Intercoolers	●	●
Safety Valves in all stages	●	●
Condensate Separators after 1 st , 2 nd , 3 rd and final stage	●	●
Combined BA Filter including Coalescing Pre-filter (0.5 mg/m ³ oil residual) and 2 large BA cartridges (AC/MS + HP), with the supply of absolutely clean air exceeding by far the requirements of EN12021	●	●
Pressure maintaining & non return valve for extended filtration	●	●
5 Kevlar filling hoses (1.2m each) with stainless steel fittings and DIN/INT'L connectors	●	●
Lever operated on/off filling valves with automatic ventilation	●	●
Interstage/Final stage Manometers	●	●
Soundproof insulation ensuring very low noise level	●	■
Automatic belt tensioning system	●	●
Automatic condensate drains with manual backups in all stages + Condensate collecting tank	●	●
High Temperature monitoring / alarm / shutdown	●	●
Low Oil level monitoring / alarm / shutdown	●	●
Secondary large fan with independent electric motor for optimum cooling (600mm diam.)	●	■
24V secondary voltage providing safety during routine operation	●	■
Main Switch & Emergency Stop button	●	■
Interstage pressure sensors providing emergency shutdown in case of overpressure	●	■
Remote Start/Stop - Remote Load/Unload	●	■
Star/Delta starter system	●	■
Electric Starter / Battery fitted	■	●
LED TOUCH controller providing operation (running hrs, filling pressure, operating temperature) & service (alarms, faults record history, maintenance hrs) data via Air Cloud App remotely	●	■
Vibration Hourmeter / Service Timer (running Hours, BA Filter / Oil service hours)	■	●
Oil Pump Lubrication System c/w oil cooler & oil filter for extreme high operating temperatures & maintain the high quality of lubricant during its lifetime	◆	◆
Special Voltage/Frequency: 230V/50-60Hz * 3x230V/60Hz * 460-480V/60Hz	◆	■
Voltage failure and Phase Rotation Safety device	◆	■
Carbon Monoxide (CO) monitoring / alarm system / shutdown system	◆	◆
Hydrogen Sulfide (H ₂ S) monitoring / alarm / shutdown system	◆	◆
Humidity (H ₂ O) monitoring / alarm system / shutdown system	◆	◆
Carbon Dioxide (CO ₂) monitoring / alarm / shutdown system	◆	◆
OIL-VOC monitoring / alarm / shutdown system	◆	◆
Dual pressure filling facility, allowing 225/330 bar simultaneous filling via pressure regulator	◆	◆
Safety Bleed valve in case of BA Cartridge absence	◆	◆

● Standard | ◆ Optional | ■ Not Applicable



Classic Diesel

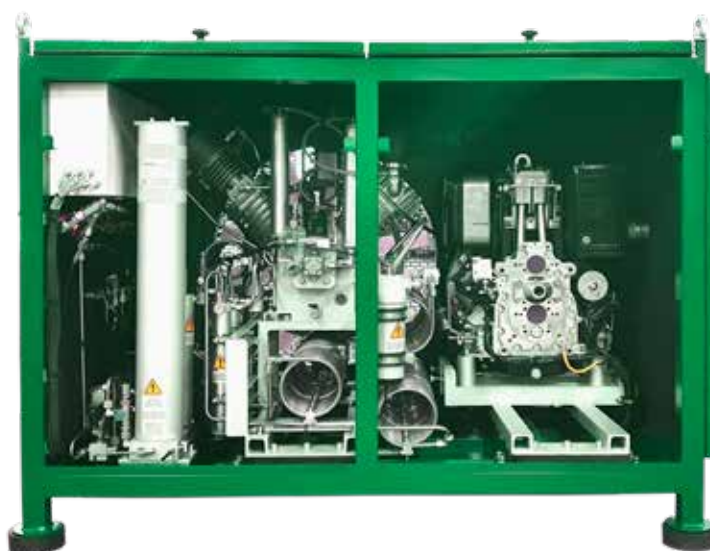

“Tailor-made solutions for each individual Gas installation.”

High-pressure piston **GAS** compressors, suitable for **Nitrogen (N₂), Helium (He) & Argon (Ar)** applications; Compact or Silent, 3+4-staged, air cooled, oil lubricated, with **Zero Loss drain system**.

Technical Data

Model	Power	Max. Pressure	FAD		Dimensions cm			Weight
		bar	m ³ /h	lit/min	L	W	H	Kg
Mistral M6-ET Classic	2.2kW/400-440V/50-60Hz	350	6.6	110	94	55	70	120
Notus N10-ET Classic	4kW/400-440V/50-60Hz	350	10.2	170	110	55	68	146
Typhoon Classic 18E	7.5kW/400-440V/50-60Hz	350	19.2	320	71	125	78	250-261
Cyclone Silent 30E	11kW/400-440V/50-60Hz	350	30	500	81	124	178	567-582
Cyclone Silent 36E	15kW/400-440V/50-60Hz	350	36	600	81	124	178	594-603



Mistral Gas



Notus Gas

Design Specifications

- Inlet Solenoid valve
- Inlet Pressure regulator
- Supply pressure safety valves
- Supply pressure manometer
- Inlet Pulsation chamber
- Inlet Safety Pressure Switch
- Inlet Vacuum Safety Pressure Switch
- Oversized Stainless Steel Intercoolers & Aftercooler in all stages for optimum cooling
- Advanced Design Cylinder Heads for optimum heat discharge
- Safety Valves in all stages
- Interstage and Final stage Condensate Separators
- Final Gas Purification Filter, including coalescing prefilter (0.5 mg/m³ oil residual) and 2x large AC/MS cartridges
- Large fan for high efficiency cooling of cylinders, intercoolers & aftercoolers, making the compressor capable for continuous operation
- Secondary large fan with independent electric motor for extra cooling (available only for Cyclone Silent models)
- Zero Loss Automatic Condensate Drain system via condensate return piping system, back inside compressor's crankcase
- Interstage and Final Stage Manometers
- Built-In Vibration Pads
- Non return valve before the outlet
- Automatic belt tensioning system
- Soundproof insulation (available only for Cyclone Silent models)
- Star/Delta starter system
- 24V secondary voltage providing safety during routine operation
- Main Switch
- Emergency Stop button
- LED TOUCH Controller (Available only for Cyclone Silent models)
- Automatic Start/Stop system at the desirable pressure
- Interstage pressure control with pressure sensors in all stages (available only for Cyclone Silent models)
- High temperature alarm & shutdown error
- Oil pump lubrication (Optional)
- Low Oil level sensor alarm & shutdown error
- Hourmeter
- Motor thermal overload protection
- Voltage failure and Phase Rotation Safety device



Typhoon Gas

Cyclone Gas



MIDDLE PRESSURE COMPRESSORS

Middle-pressure piston compressors, suitable for any INDUSTRIAL application; Open Framed, 2-staged, air cooled, oil lubricated.
Models: Mistral & Typhoon.

Technical Data

Model	Power	Max. Pressure	FAD		Dimensions cm			Weight
		bar	m ³ /h	lit/min	L	W	H	Kg
Mistral M6-ET 40b	2.2kW/400-440V/50-60Hz	40	10	166	74	40	48	60
Typhoon Open 15E 40b	5.5kW/400-440V/50-60Hz	40	24	400	109	54	71	185-190
Typhoon Open 18E 40b	7.5kW/400-440V/50-60Hz	40	30	500	109	54	71	190-195



Mistral 40b

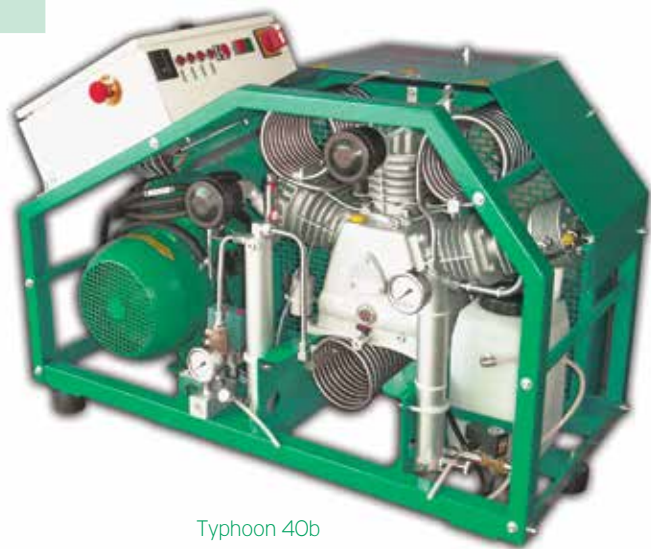

Typhoon 40b

REFRIGERATED DRYER "CRYO"

HPRD 600

Model	Power	Max. Working Pressure	Capacity		Dimensions cm			Weight
		bar	m ³ /h	lit/min	L	W	H	Kg
HPRD600	230V AC / 50-60Hz	350	36	600	53	58	48	43

- +3 °C dew point.
- R134a CFC Free refrigerant.



HUMIDITY CONTROL SYSTEM

Model	Power	Max. Working Pressure	Dimensions cm			Weight
		bar	L	W	H	Kg
HC	230VAC 50-60Hz or 24VAC 50-60Hz or 24VDC	420	12.3	20	11.2	2.2

- Accurate humidity sensor in stainless steel chamber.
- Central monitoring unit with digital display.



HC

STORAGE SYSTEMS

- Powder coated steel frame
- 50/80 lit. Cylinders
- Working Pressure up to 450 bar
- Custom design availability
- Reverted cyclinders for no moisture accumulation at their bottom



FILTRATION SYSTEMS

- Wall mounted powder coated steel frame
- BA Filter(s) (Coalescing Prefilter & BA cartridges)
- Manual and/or Automatic condensate drains



FILLING PANELS

- Breathing air filling panels
- Automatic priority filling panels
- Paintball filling panels
- Custom design availability



- Kevlar filling hoses with lever operated filling valves
- Dual pressure filling facility 225/330 bar
- Wall mounted powder coated steel frame



KEVLAR FILLING HOSES

DIN200/300 FILLING CONNECTORS & YOKE ADAPTORS



LEVER FILLING VALVES



PRESSURE MAINTAINING VALVES



SAFETY VALVES



PARAMINA

Air Compressors Manufacturers



We are proud of our consistent

- ✓ Product Quality
- ✓ Experience
- ✓ Specialization
- ✓ Reliability

*now spanning over **58 years!***

FIND US ONLINE



PARAMINA SA

Byway Evagelistrias str., 19300 Aspropirgos, Greece
Tel: +30 210 5575860-1

www.paramina-compressors.com | info@paramina.gr

[paramina.compressors](https://www.facebook.com/paramina.compressors) | [paramina_aircompressors](https://www.instagram.com/paramina_aircompressors)
 PARAMINA Air Compressors Manufactures